

## SLS TOMCAT X02DA

### Sample holder specs for users

---

#### Standard sample holder

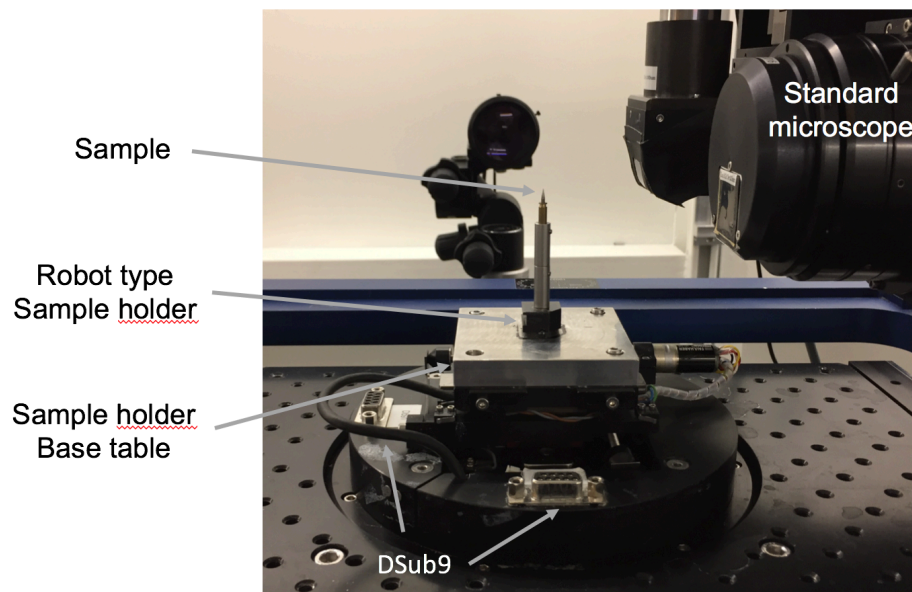

#### High sample holder

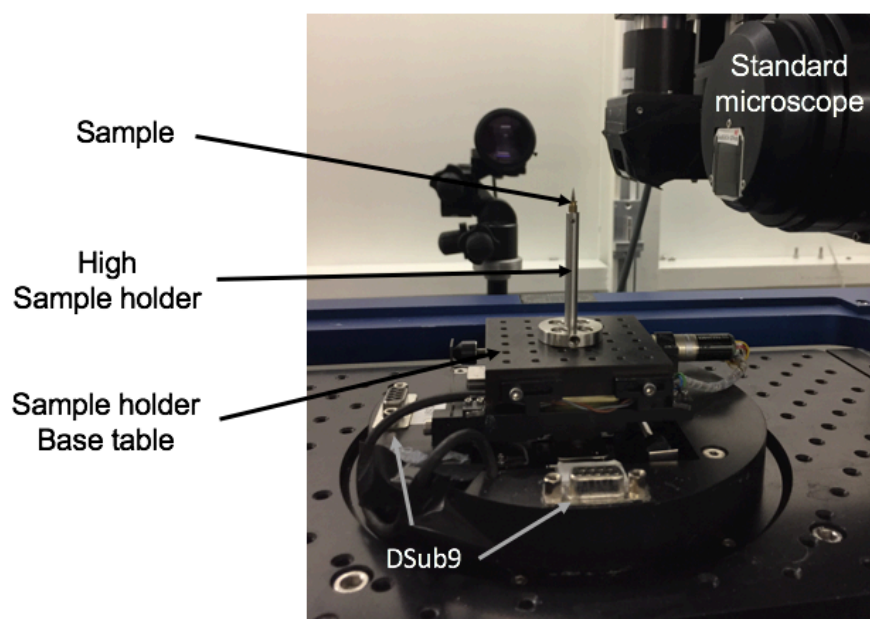

## Sample holder base plate:

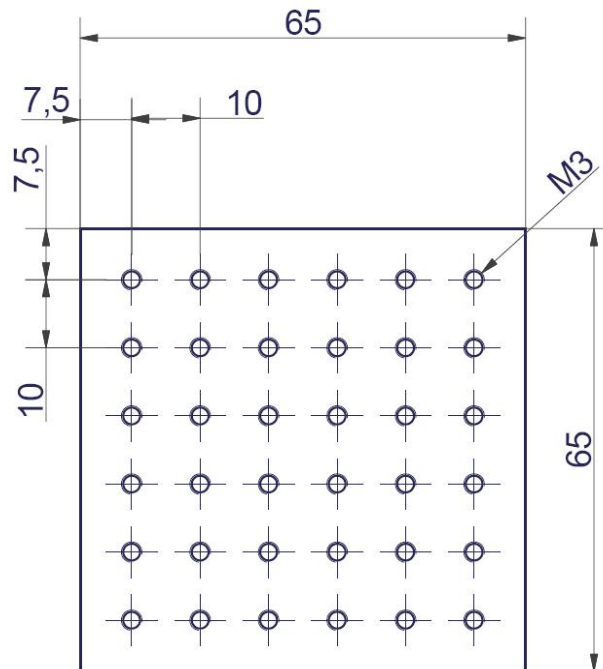

### Rotation stage / sample base table information:

The base plate is 6 mm thick, and the holes are not going through.

The **maximum weight** supported by the rotation stage is 2kg.

The travel range of the vertical axis of the sample manipulator (Y) relative to its nominal zero position is +/- 20mm.

The total sample height (sample at point of interest plus holder height) cannot be more than:

- 139 mm for white beam experiments
- 146 mm for monochromatic experiments using the multilayer mono @  $E > 21$  keV
- 149 mm for monochromatic experiment using the multilayer mono @  $E \leq 21$  keV
- 168 mm for monochromatic experiment using the Si(111) monochromator

These heights correspond to the distance from the top of the standard base plate to the beam reference height. The heights are calculated for the ES1 table down at its lowest possible Y position, and the sample Y stage at its nominal zero position.

We have two RS232 connectors – Dsub 9 available through the slip ring. The maximum supported electrical current is **1 Amp per wire and 115V**.

The connectors on the stage are female.

## Sample holder description

### 1- Magnetic/Robot sample holder

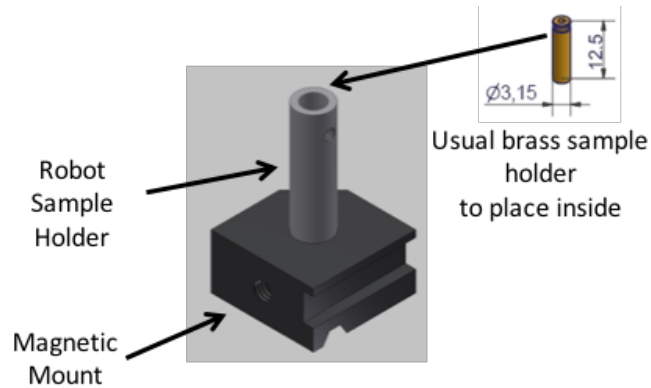

Note that the pin is screwed on the side of the robot sample holder. Ideally the pin or the sample should have a diameter of 3,15mm or smaller but not larger.

### 2- Goniometer sample holder

If you need to tilt your sample, you can use our goniometer.

The sample will be placed 84mm from the sample holder base table on the usual magnetic mount.

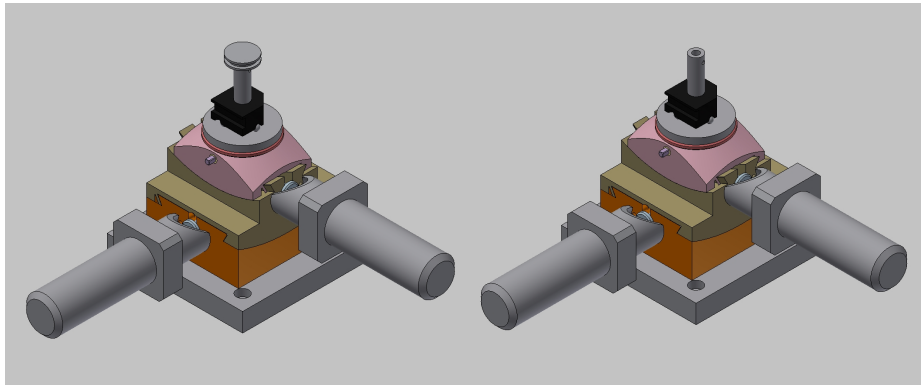

### 3- High Sample holder description:

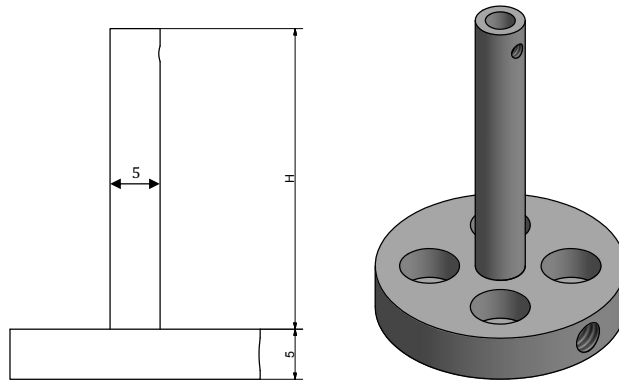

This sample holder is for pin diameter of 3.15mm

The fixation of the pin is easily done by a screw like for the usual sample holder.

The screws to attach the holder to the base plate are M3, max height 8mm.

Different heights are available:

- H=20 mm
- H=35 mm
- H=50 mm
- H=65 mm

## Sample holder references:

Order information:

Huber Diffraktionstechnik  
Sommerstr. 4

83253 Rimsting  
Germany  
www.xhuber.com  
Tel: +49 (0) 8051 68780  
Fax: +49 (0) 8051 687810  
e-mail: info@xhuber.com  
Order No.: 1002-18MS Präparateträger

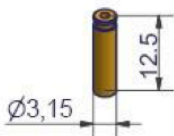

Order information:

PLANO GmbH  
Ernst-Befort-Strasse 12

85578 Wetzlar  
Germany  
www.plano-em.de  
Tel: +49 (0) 6441 97650  
Fax: +49 (0) 6441 976565  
e-mail: plano@plano-em.de  
Order No.: G301 Probenhalter / G301S Stiftprobenhalter mit Schlitz

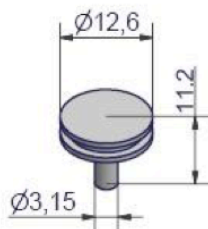

Special sample pin with 0.3mm  
diameter  
For very small samples

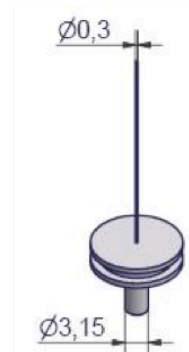

***For support or further information please contact us:***

***Your local contact:*** <https://www.psi.ch/sls/tomcat/people>

***Our beamline technicians:***

*Gordan Mikuljan and Philipp Zuppiger*

E-mail: [gordan.mikuljan@psi.ch](mailto:gordan.mikuljan@psi.ch) or [philipp.zuppiger@psi.ch](mailto:philipp.zuppiger@psi.ch)

Phone: +41 (0)56 310 54 46 or +41 (0)56 310 35 30